

CAB382

Eaton's Cooper loop connected LED beacon



The intelligent addressable loop connected LED beacon (CAB382) is available to complement audible alarms for use in areas either where people may be present who have impaired hearing or areas with high ambient noise levels.

The (CAB382) is compatible with Eaton's Cooper range of intelligent addressable fire systems.

This device is designed for both wall and ceiling mounting, has a built in short circuit isolator and is soft addressed for ease of installation.

Features

- Loop powered
- Soft addressed
- Integral short circuit Isolator
- High efficiency design
- High output LED beacon
- Low profile design

Benefits

- Quick and simple to install
- High efficiency visual unit
- Low current consumption
- First fix back box
- Easy to maintain/service

Technical Specification

Code	CAB382
Description	Loop Connected LED Beacon
Specification	
Operating Voltage	17V dc to 32V dc
Standby Current	< 250µA
Alarm Current	< 4.1mA
Flash Frequency	1/2Hz
Environmental	
Operating Temperature	-10°C to +55°C
Humidity (Non Condensing)	0 to 95% RH
Physical	
Construction	PC/ABS
Colour	Red
Lens Colour	Red
Dimensions (Dia x D)	95mm x 53mm
Weight	0.15kg
Ingress Protection	IP54
Compatibility	
Suitable for use with	Cooper Intelligent Addressable Fire Systems

Installation

1. Installation is simple using first fix base.
2. First fix base is fixed to mounting surface via 2 fixings holes.
3. Cable entry is from the rear.
4. Connections are to connector block on beacon body.
5. Beacon body is pressed into first fix base then twisted to lock into position.

Dimensions

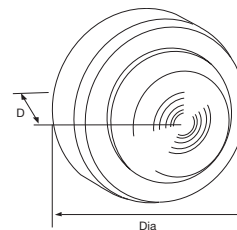

Dia (mm) D (mm)

95	53
----	----

Standard Connections

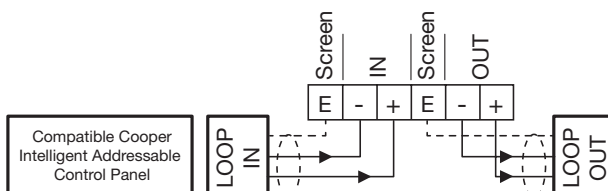

WARNING:
Do NOT use high voltage testers if ANY equipment is connected to the system.

Screen (Earth) must be continuous along entire length of loop.

System Functionality

1. Utilises multiple LED's combined with careful optical design to provide high intensity flash with low current consumption.
2. Low profile design for discreet installation.

Catalogue numbers

Description	Code
Loop Connected LED Beacon	CAB382